

----- Ratchet tie-down strap as a loop 4000kg

Section A-A

Scale 1:200

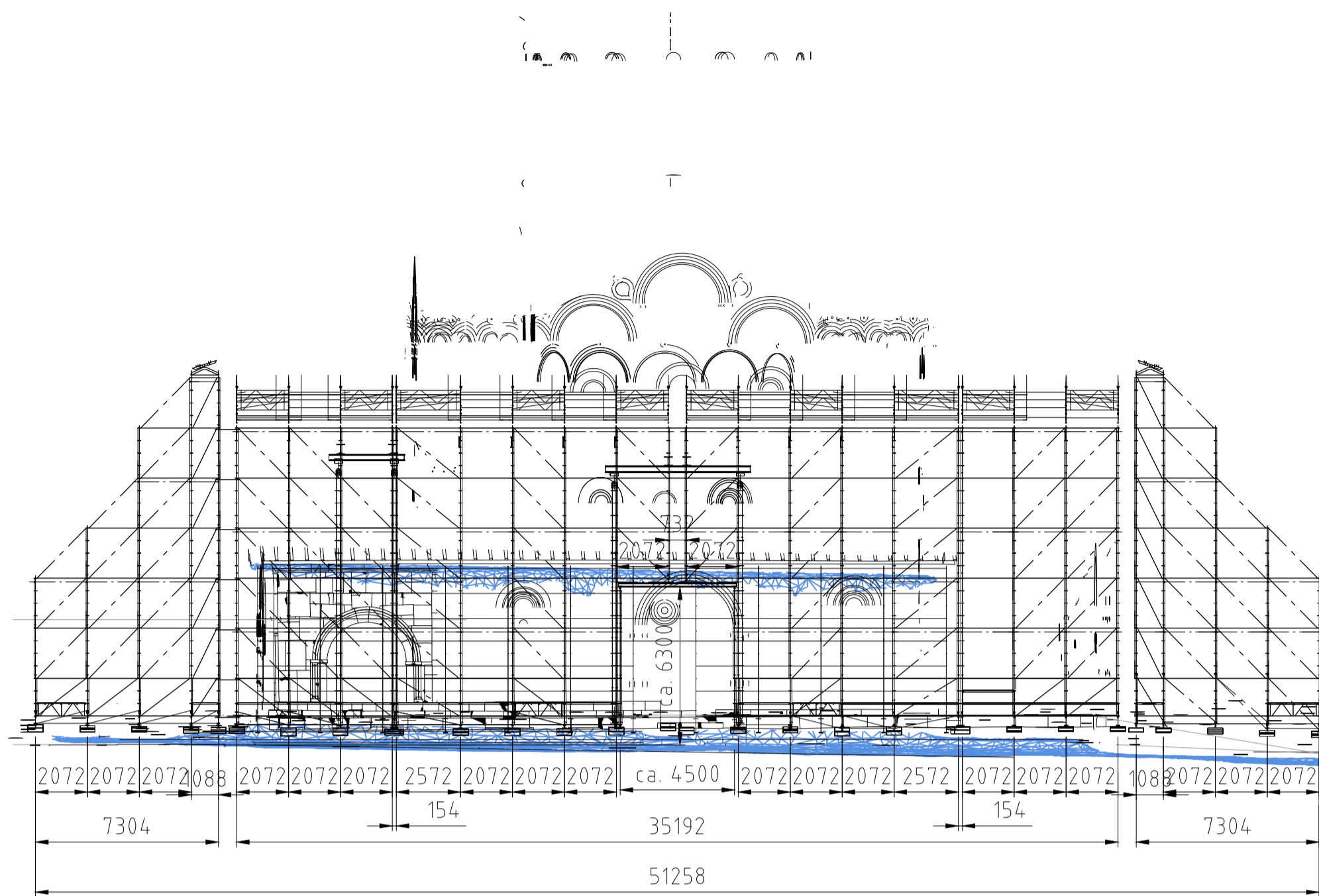

Section B-B

Scale 1:200

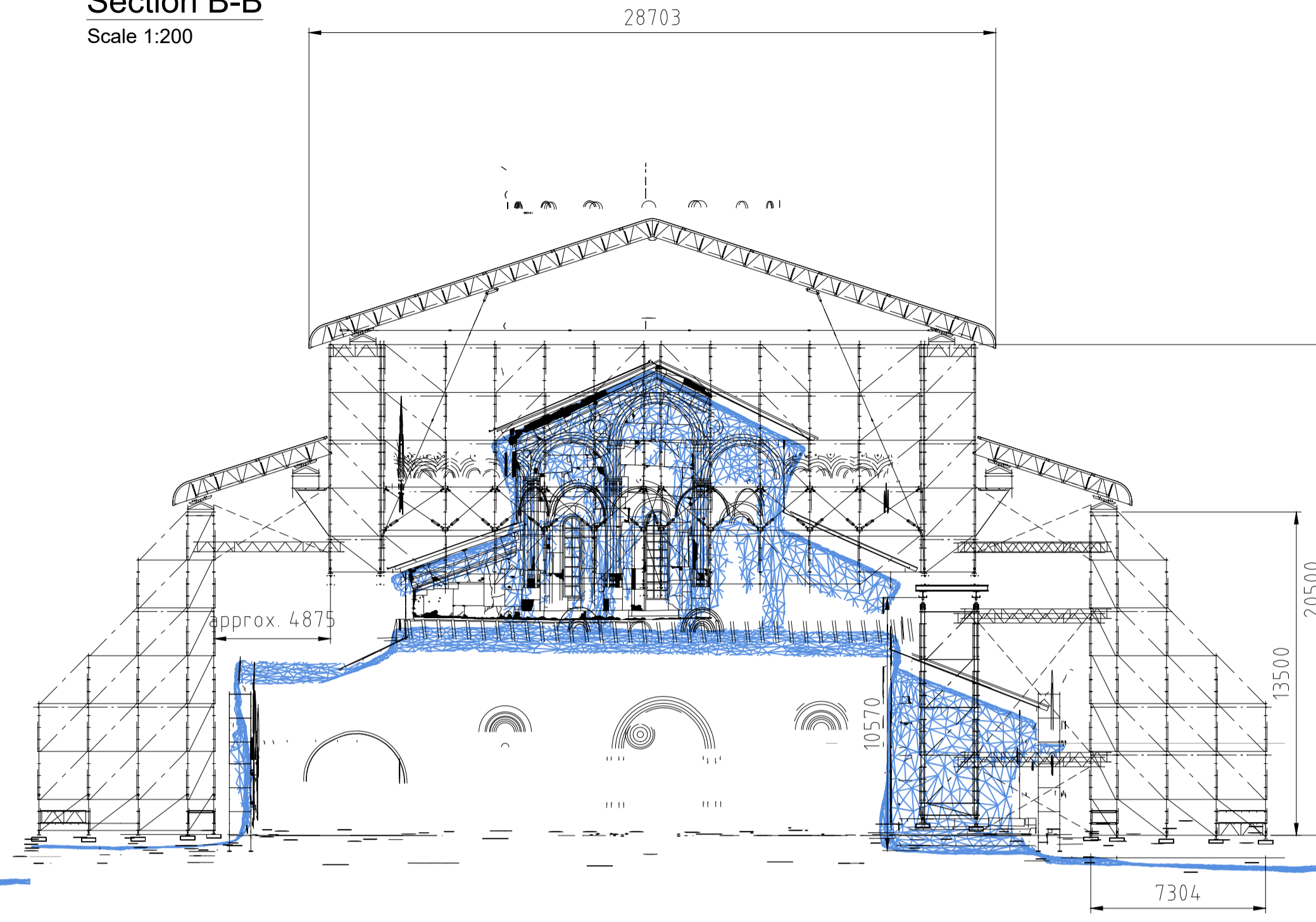

Section C-C

Scale 1:200

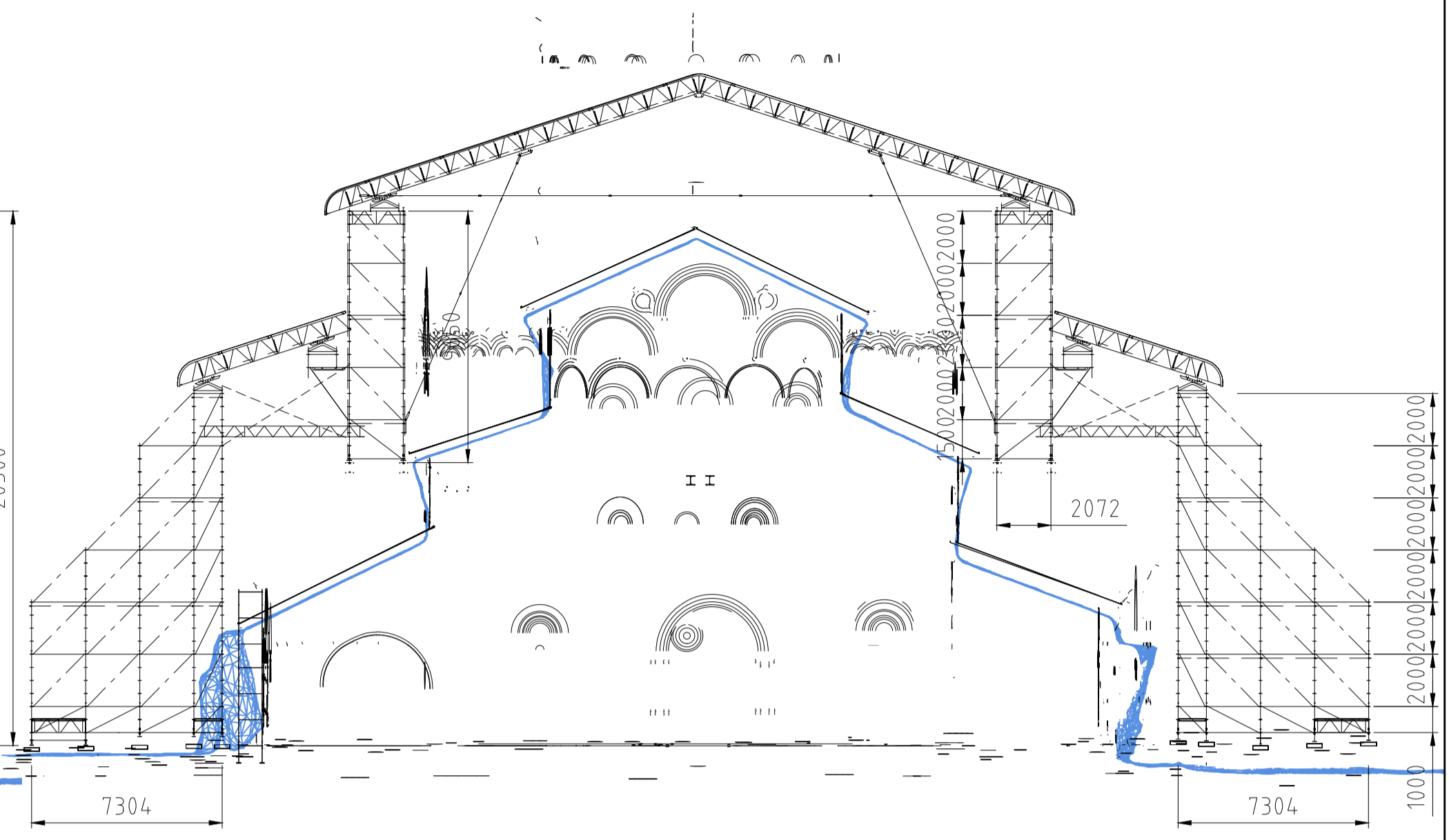

Section D-D

Scale 1:200

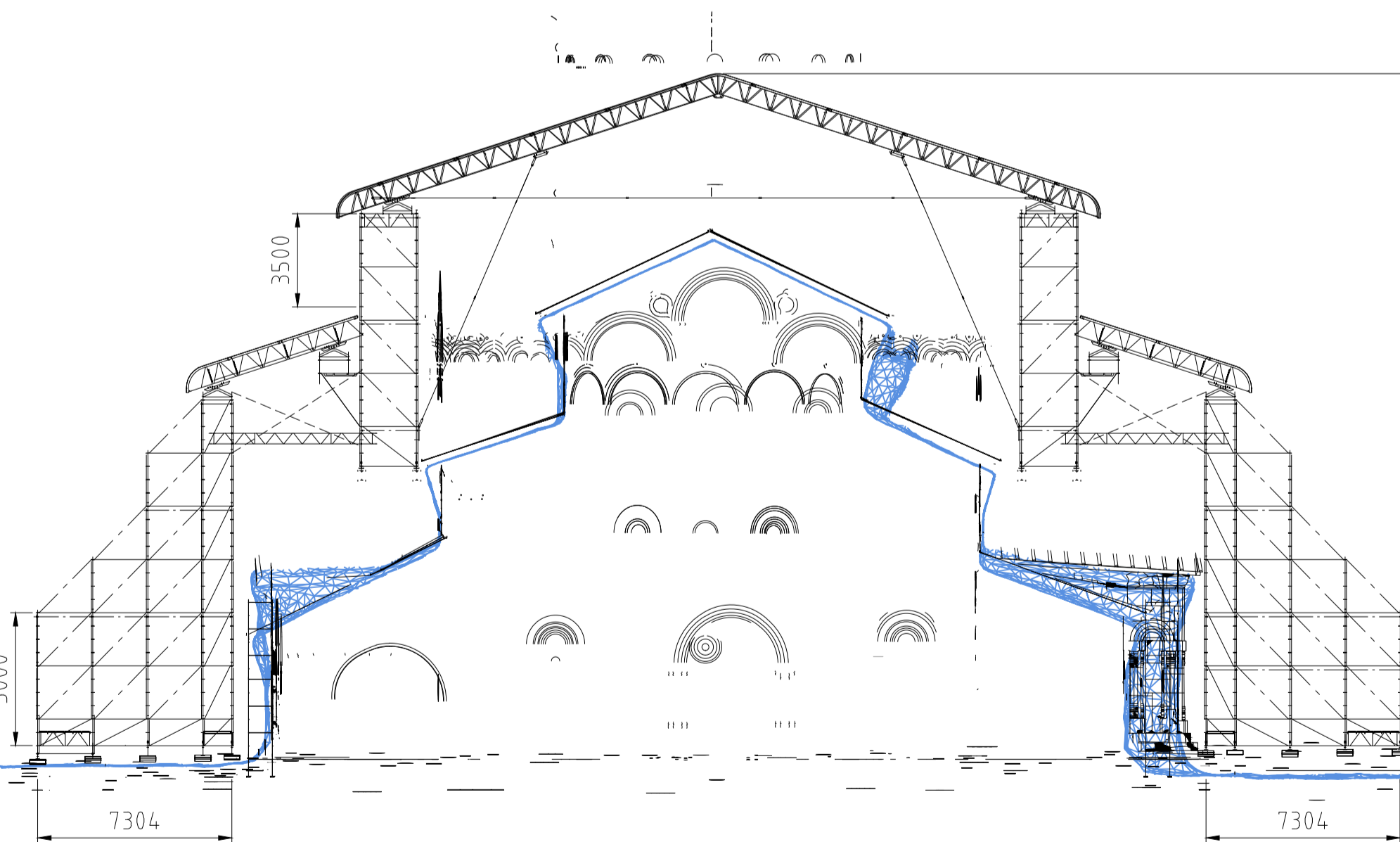

Section E-E

Scale 1:200

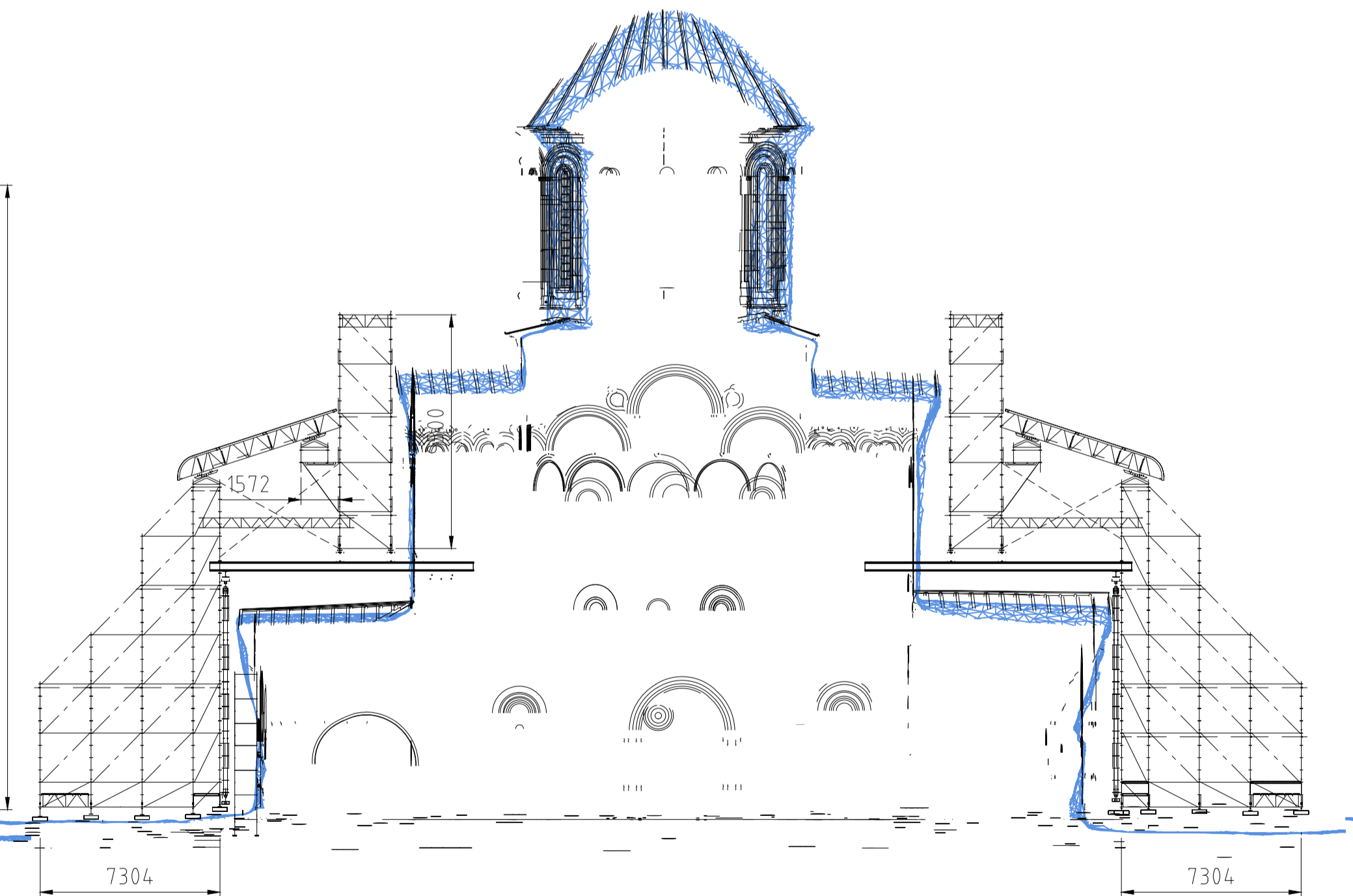

Section F-F

Scale 1:200

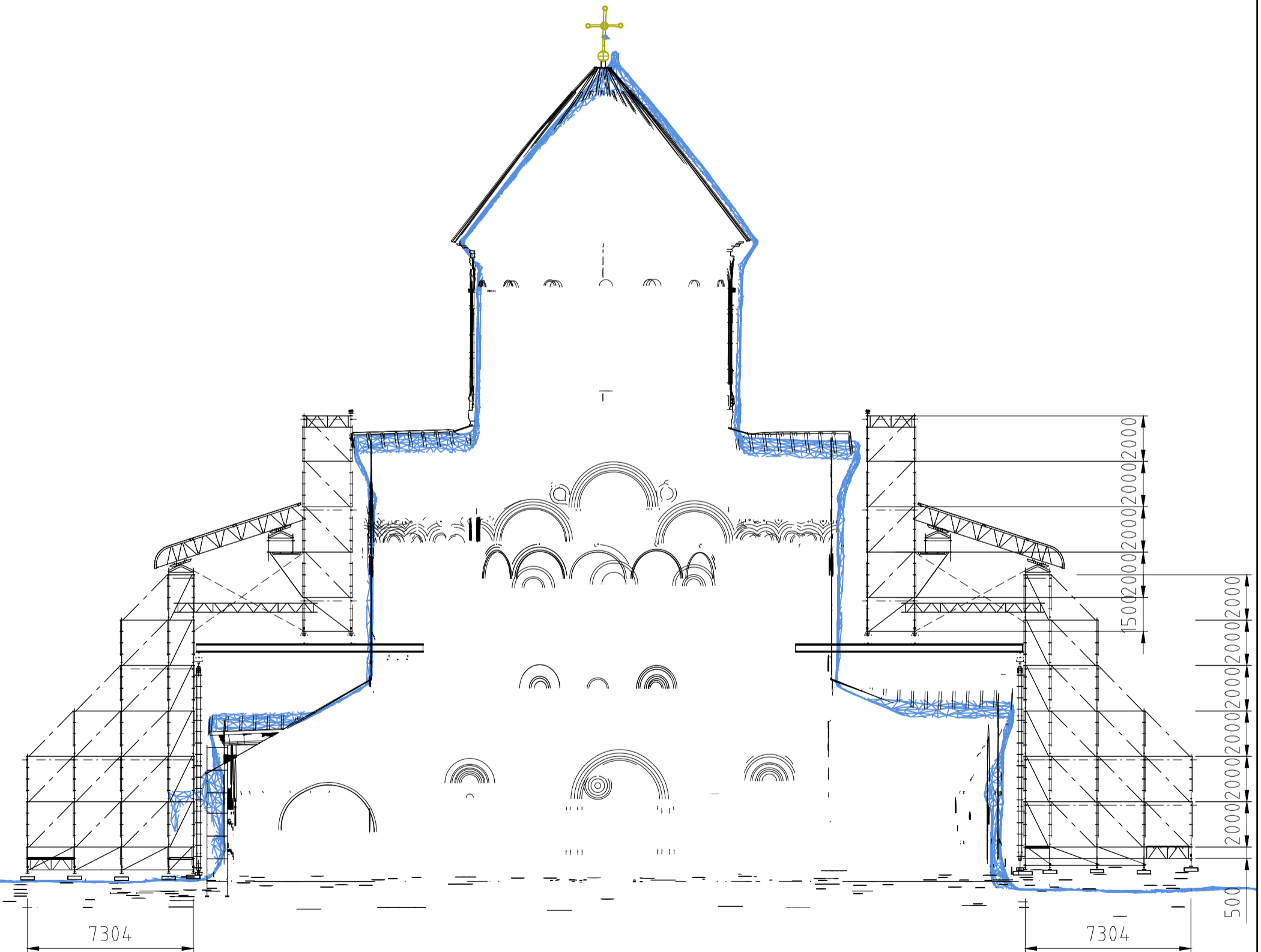

Steel beams, ratchet tie-down strap and ballast are to be provided on site, according to Knobloch Consulting Engineers.

- N.B.
- This drawing was prepared on the basis of the information provided. Statutory compliance and suitability for use to be verified on site.
  - The construction is based upon empirical values without a detailed structural design. All details are exemplary and non-binding. Before assembly, structural integrity is to be checked. Extra material is to be provided on site as necessary and is not included in this drawing.
  - Assembly instructions as well as any special instructions in the technical offer are to be adhered to.
  - Structure to be founded on ground of suitable load-bearing capacity. Load distribution to be provided as necessary. Load transfer in to substructure or ground to be checked as necessary.
  - Ties, ballast or guylines to be provided as structurally necessary.
  - Plan dimensions are centre to centre unless otherwise stated.

- Calculations and load tables for standard applications are available for the roof trusses. As a rule, the overall structure (roof + roof support structure, anchorage, ballast, etc.) must be assessed and approved on an individual basis by a person competent in scaffolding design or by a professional engineer.
- Drainage to be assured on site by suitable means.
- Roof slope to ensure drainage of the roof: min. 15° (Keder roof), min 11° (steel cassette roof).
- Structure to be closed on all sides! Cladding of side and gable walls to be provided on site.
- Cladding with scaffold tarpaulins or keder tarpaulins:
  - spacing of tarpaulin connectors ≤ 30 cm
  - spacing of rail mounts ≤ 1.0 m
- Gap between wall cladding and roof to be closed on site using suitable measures.
- Keder rails are to be cut to length on site if necessary.
- Joints of standards subjected to tensile forces are to be secured by suitable means (e.g. bolted spigots or LW-standards).



<https://autode.sk/3KvLtsE>



<https://autode.sk/3KvLtsE>

3D Model (blue)

Draft proposal - not approved for construction.

This drawing is valid in conjunction with the use of original Layher material only. Detailed information on components see parts list. Dimensions and geometry to be verified on site. Extra Material to be provided on site as necessary. All details are subject to the valid Terms and conditions available at [www.layher.com](http://www.layher.com).

No.	Alteration	Date	Name

Drawn	Date	Name
	07.07.2023	QUESADA

**Layher**

More Possibilities. The Scaffolding System.

Wilhelm Layher GmbH & Co KG  
Postfach 40  
D-74361 Guggingen-Ebensbach  
Tel: (07135) 70-0 / Fax: 70-309  
E-Mail: [info@layher.com](mailto:info@layher.com)

The reproduction, distribution and utilization of this document as well as the communication of its contents to others without express authorization is prohibited. Offenders will be held liable for the payment of damages. All rights reserved in the event of the grant of a patent, utility model or design. Refer to protection notice ISO 16016.

Scale		Drawing No.
@A1 1:200	KD Keder Roof XL Gelati Monastery	2 AR 44898-1023.F







Front View  
Scale 1:200

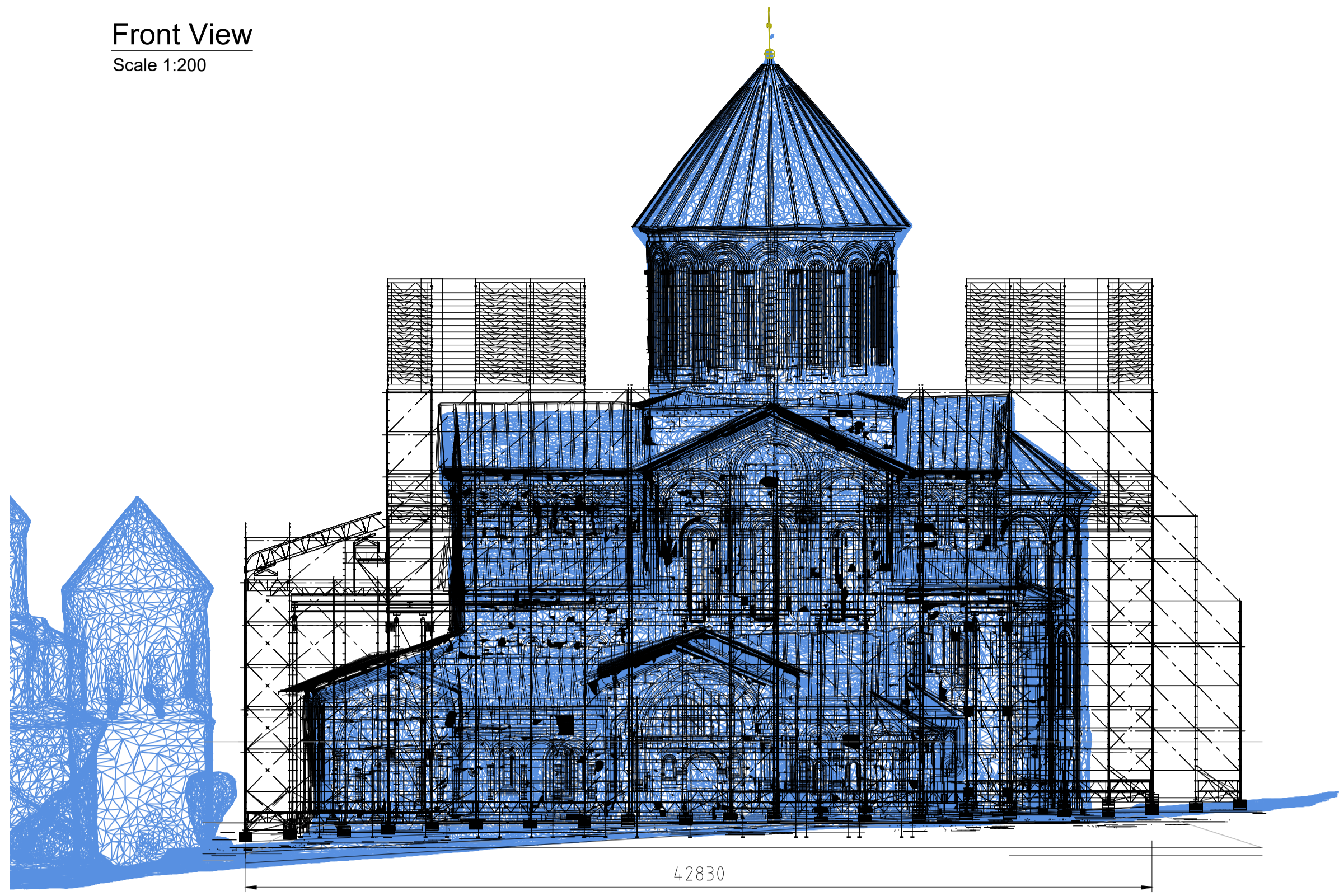

Side View  
Scale 1:200

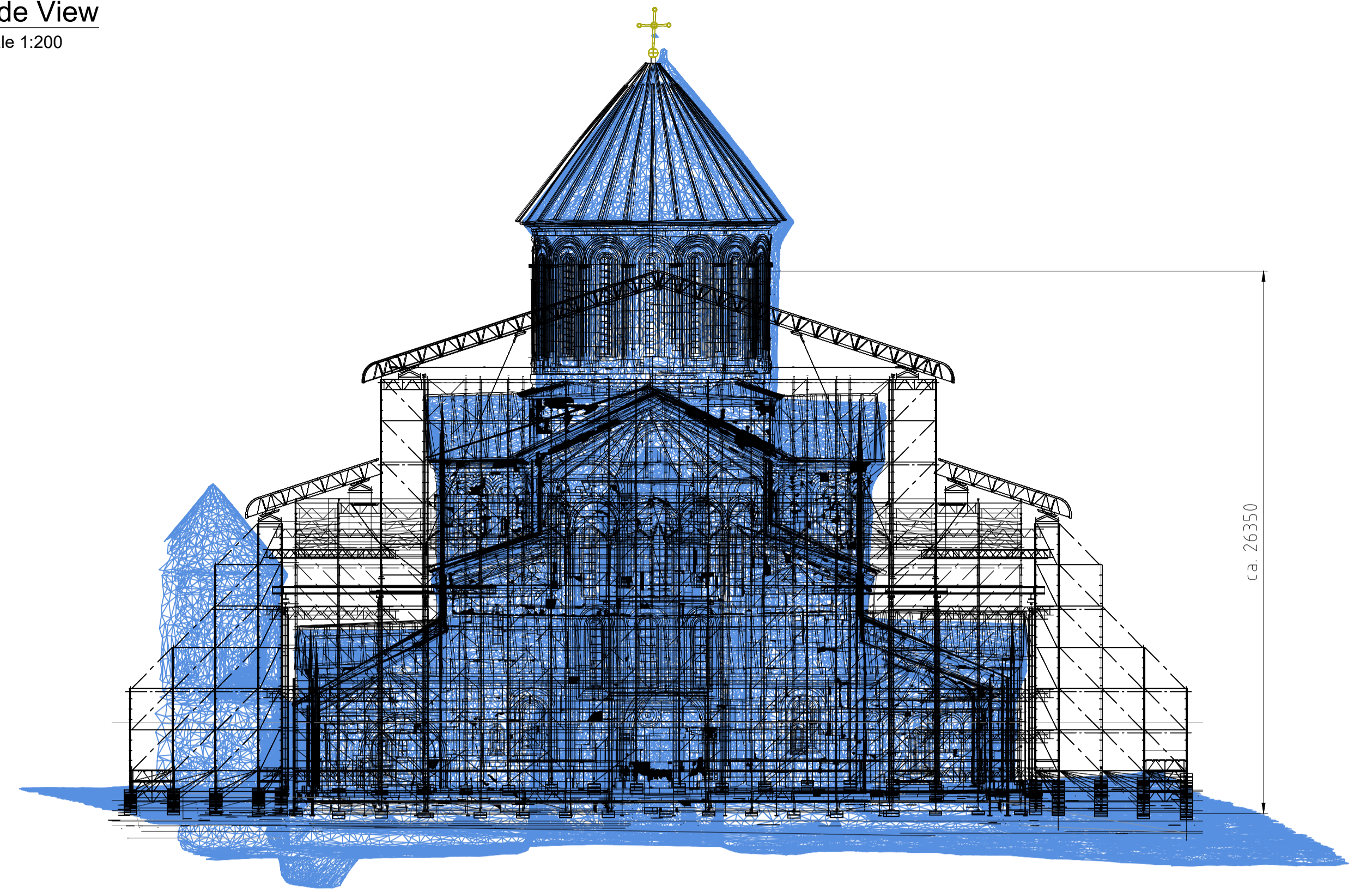

Top View  
Scale 1:200

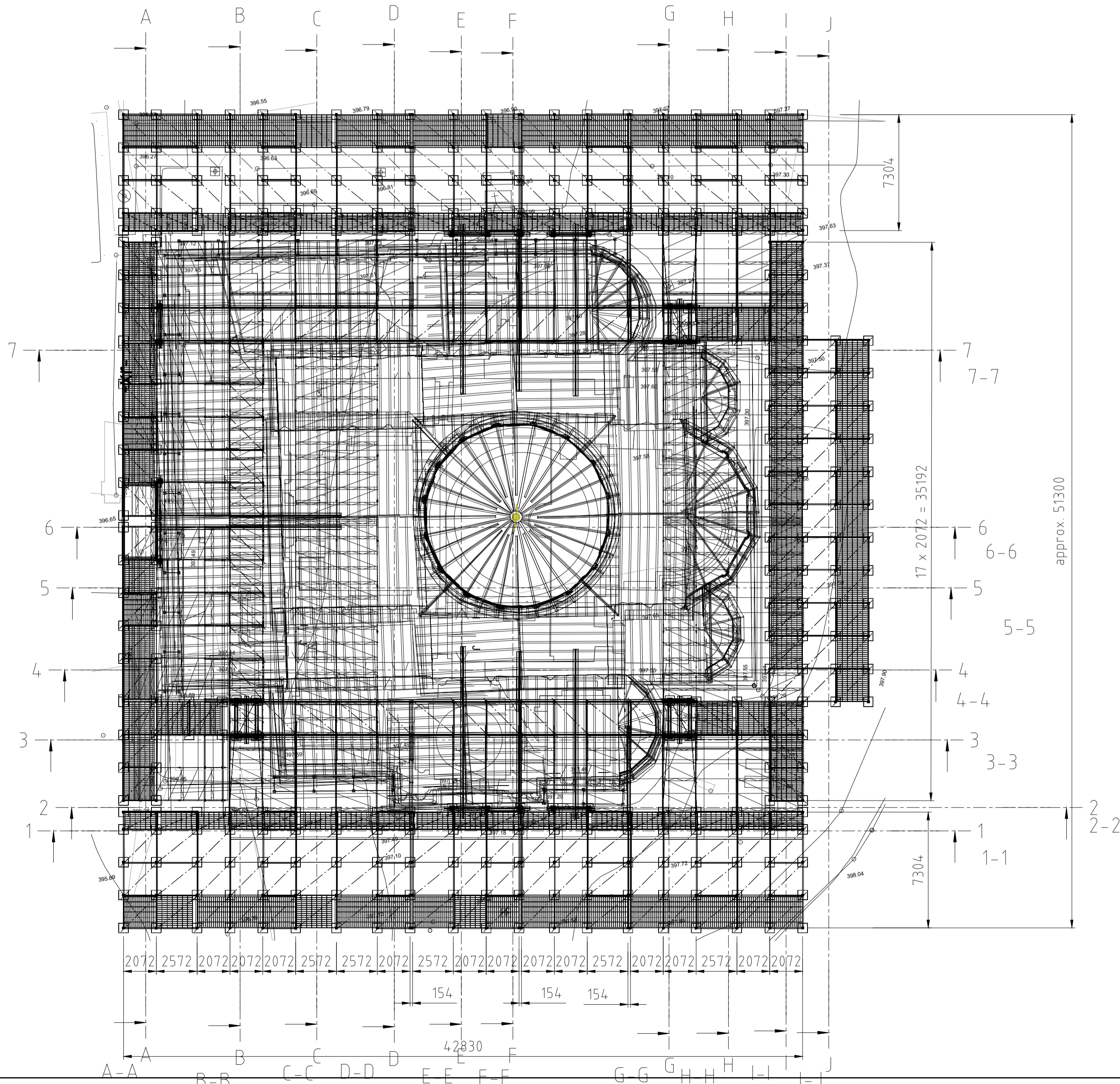

Steel beams, ratchet tie-down strap and ballast are to be provided on site, according to Knobloch Consulting Engineers.

Isometric view  
n.t.s.



<https://autode.sk/3KvLtsE>



<https://autode.sk/3KvLtsE>

3D Model (blue)

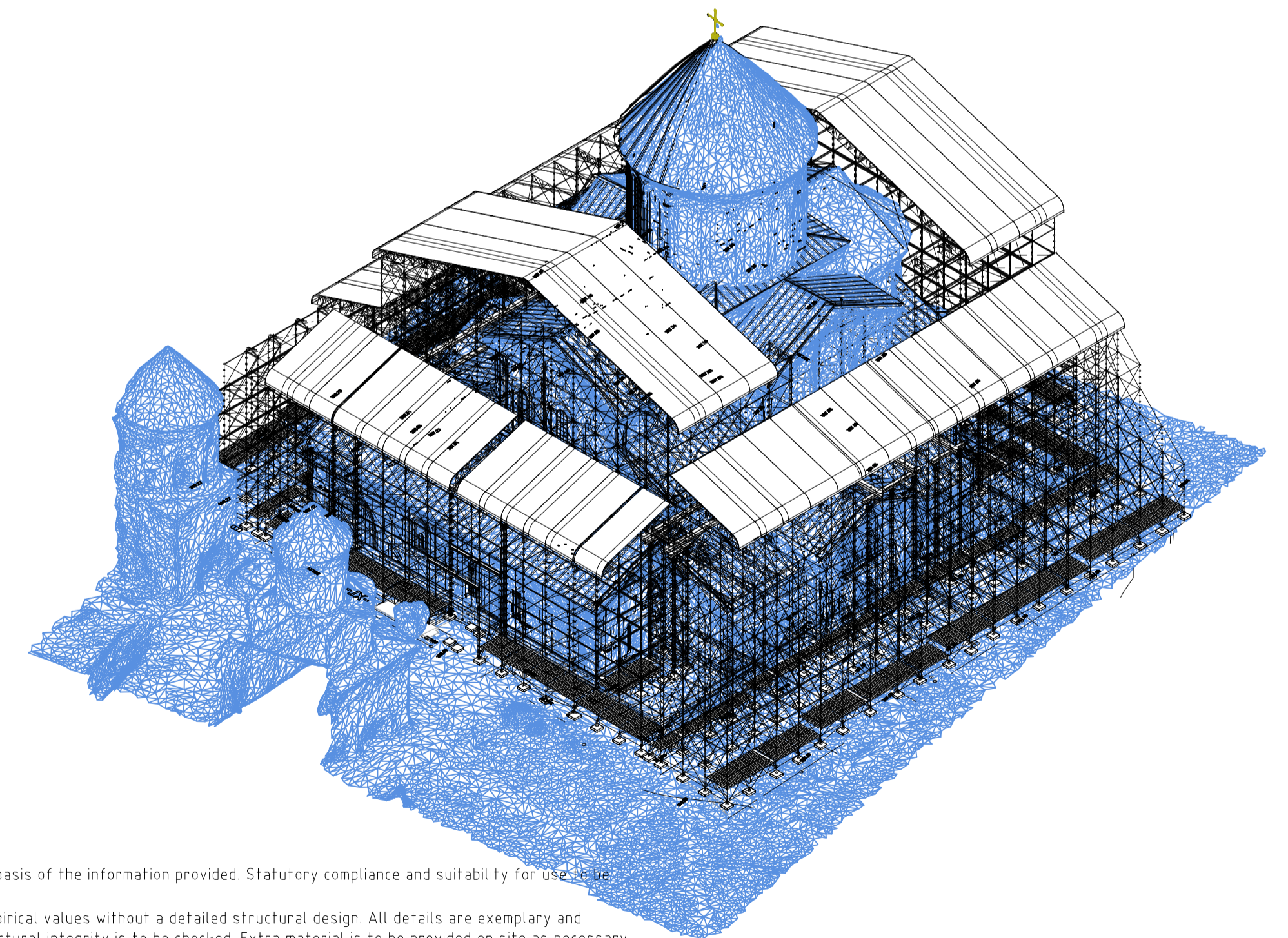

**N.B.**

- This drawing was prepared on the basis of the information provided. Statutory compliance and suitability for use to be verified on site.
- The construction is based upon empirical values without a detailed structural design. All details are exemplary and non-binding. Before assembly, structural integrity is to be checked. Extra material is to be provided on site as necessary and is not included in this drawing.
- Assembly instructions as well as any special instructions in the technical offer are to be adhered to.
- Structure to be founded on ground of suitable load-bearing capacity. Load distribution to be provided as necessary. Load transfer in to substructure or ground to be checked as necessary.
- Ties, ballast or guylines to be provided as structurally necessary.
- Plan dimensions are centre to centre unless otherwise stated.
- Calculations and load tables for standard applications are available for the roof trusses. As a rule, the overall structure (roof + roof support structure, anchorage, ballast, etc.) must be assessed and approved on an individual basis by a person competent in scaffolding design or by a professional engineer.
- Drainage to be assured on site by suitable means.
- Roof slope to ensure drainage of the roof: min. 15° (Keder roof), min 11° (Steel cassette roof).
- Structure to be closed on all sides! Cladding of side and gable walls to be provided on site.
- Cladding with scaffold tarpaulins or keder tarpaulins:
  - spacing of tarpaulin connectors ≤ 1,0 m
  - spacing of rail mounts ≤ 1,0 m
- Gap between wall cladding and roof to be closed on site using suitable measures.
- Keder rails are to be cut to length on site if necessary.
- Joints of standards subjected to tensile forces are to be secured by suitable means (e.g. bolted spigots or LW-standards).

**Draft proposal - not approved for construction.**

This drawing is valid in conjunction with the use of original Layher material only. Detailed information on components see parts list.  
Dimensions and geometry to be verified on site. Extra Material to be provided on site as necessary.  
All details are subject to the valid Terms and conditions available at [www.layher.com](http://www.layher.com).

No.	Alteration	Date	Name

Drawn	Date	Name
	07.07.2023	QUESADA

**Layher**   
More Possibilities. The Scaffolding System.  
Wilhelm Layher GmbH & Co KG  
Postfach 40  
D-74361 Guglingen-Ebensbach  
Tel.: (07135) 70-0 / Fax: 70-309  
E-Mail: [info@layher.com](mailto:info@layher.com)

The reproduction, distribution and utilization of this document as well as the communication of its contents to others without express authorization is prohibited. Offenders will be held liable for the payment of damages. All rights reserved in the event of the grant of a patent, utility model or design. Refer to protection notice ISO 16016.

Scale		Drawing No.
@A1 1:200	KD Keder Roof XL Gelati Monastery	1 AR 44898-1023.F